



The DYNAMIK Internal Sports Wall provides a durable and cost effective solution for sports hall environments. With high scratch and impact resistance, the panels are designed to be an integral component of the internal wall construction and be fitted from floor to soffit. Alternatively, the solid panels can be replaced with matching or contrasting perforated (acoustic) panels to provide a continuous, flush wall finish.

## Principle Features

**Durability & Impact Resistance** – Provides superior impact resistance from balls, equipment and hall users. This allows for both solid and acoustic panels to be used from floor to soffit.

**Time & Cost Savings** – The structural integrity of the panels enables them to be installed as an independent wall system which can be fixed directly to studwork. This eliminates the need for block work and other wet trades, providing a fast and efficient installation.

**Factory Finished** – Every panel is factory finished with a low maintenance, UV resistant, durable surface that does not require re-finishing over the life of the product.

**Secret Clip Fixings** – The supplied secret clips offer a fast and easy panel installation which eliminate unsightly surface fixings. They also provide a consistent spacing between adjoining boards.

**Fire Performance** – The panels are fire rated to comply with Building Regulations, Sport England and the Department of Education - Education & Skills Funding Agency (ESFA) requirements.

**Colours** - The panels are available in a range of colours & wood effects to provide a modern appearance that complements the sports floor and can achieve the required Light Reflectance Values (LRVs).

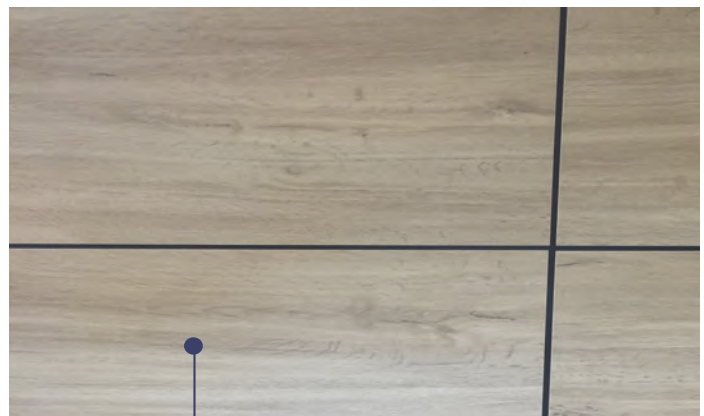

Solid panel

Perforated (acoustic) panel

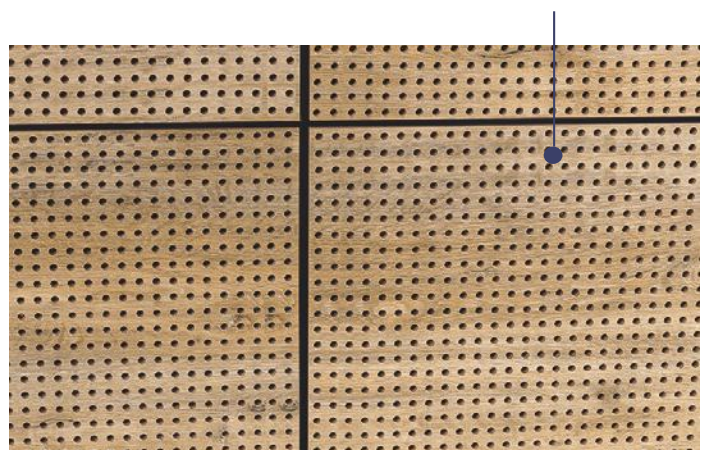

## Technical & Performance Specifications - Solid & Perforated (Acoustic) Panels

Panel Face	Factory finished, available in a range of colours & wood effect finishes
Panel Core	Fire Rated MDF
Fire Performance	Fire rated to European Class B - S1-d0
Panel Sizes (l x w x d)	2.4m x 1.2m x 18mm (confirm prior to design) 2.4m x 592mm x 18mm (confirm prior to design)
Compliance	Building Regulations, ESFA & Sport England compliant
Panel Weight	<i>Perforated</i> <i>Solid</i> 10.93kg - 14.00kg / m <sup>2</sup>
Acoustic Performance	Class C - Perforated panels with insulation

### Installation

The panels can be fixed to metal or timber vertical/horizontal studwork at 400mm centres. A black acoustic fleece is placed over the studwork to “effectively” hide the gap between the panels and make the black metal brackets appear “invisible”. The panels are then installed using the supplied secret clips to ensure a consistent 7mm spacing between adjoining boards. Insulation can be incorporated behind the panels to enhance thermal resistance and acoustic performance.

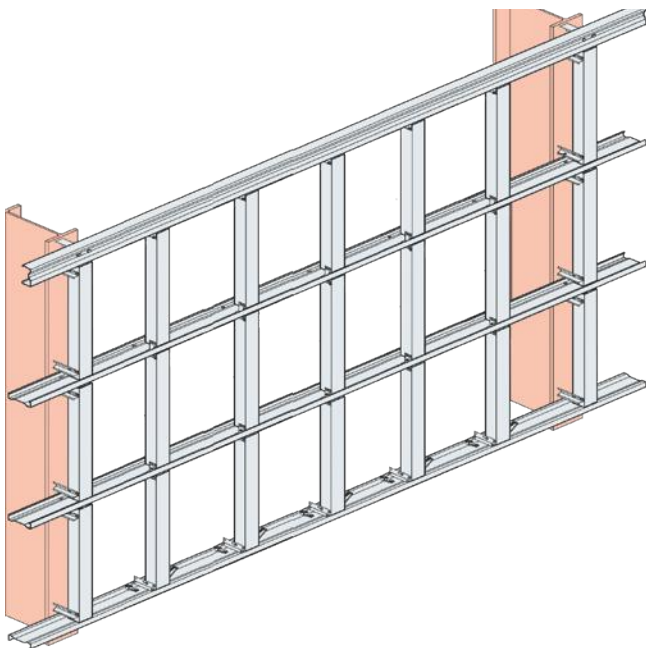

Typical vertical/horizontal studwork construction at 400mm centres to accommodate the installation of the panels.



Insulation must be placed behind the panels to achieve required thermal and acoustic values.

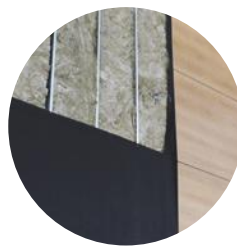

An acoustic fleece is installed behind the panels to hide stud work and disguise the fixing clips.



The panels are fixed using the secret clips which are to be placed into the pre-routed edges to leave the appearance of a fixture free installation.



BIM

[www.nationalbimlibrary.com/dynamik-sports-floors](http://www.nationalbimlibrary.com/dynamik-sports-floors)



NBS

[www.ribaproductselector.com/dynamik/27790/overview.aspx](http://www.ribaproductselector.com/dynamik/27790/overview.aspx)

*\*Product specifications may be subject to change without notice, please contact DYNAMIK for the latest product information*